

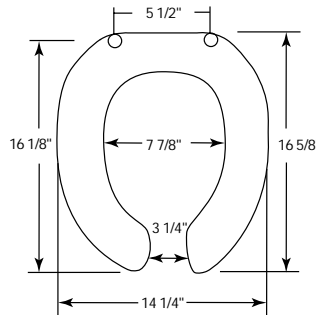

Seats shall be No. _____ as manufactured by Church Seats. Seats shall contain DuraGuard®, an antimicrobial agent. Seats shall be heavy weight and injection molded of solid plastic. Seats shall be open front less cover for regular bowl and feature large molded-in bumpers. External check hinges to feature 300 Series stainless steel posts that stop seat 11 degrees beyond vertical. Uses 300 Series stainless steel hardware. Color to be white. Hinges shall be _____.

MODEL 2055C

- REGULAR SEAT
OPEN FRONT LESS COVER
- SOLID PLASTIC
- DURAGUARD®
ANTIMICROBIAL AGENT

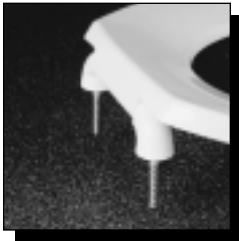
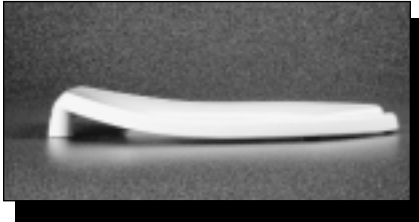

- 2055C Open front seat less cover/external check hinge stops seat 11° beyond vertical.
 - 2055SSC Open front seat less cover/stainless steel, self-sustaining and external check hinge holds seat in any raised position up to 11° beyond vertical.
- Ring thickness is 13/16"
 Ring thickness including the bumper is 1"
 Height of the seat is 2-1/4"

